

GMS 

Thermal Products Ltd

www.gmsthermal.co.uk



**BOILER HOUSE PRODUCTS
VENT HEADS**

GMS VENT HEADS

General

Vent heads are used on GMS blow down vessels, hotwell tanks and condensate pump sets. They are designed to remove water from discharged steam. The vented steam hits the internal baffle plate before discharging to atmosphere and any residue water drains out of the head.

Installation

The vent head is fitted in the required position using the screwed or flanged connection. Suitable sealant or gaskets should be used on the joint.

The drain should be checked annually to ensure no blockages in the pipework.

Use Caution: The drain needs to be piped to a safe location.

Material Options:

Stainless Steel AISI 304L
 Stainless Steel AISI 316L
 Galvanised Mild Steel

Connection Flange Options:

Standard: VH50 Screwed 2" BSP BS21
 VH80+ Flanged BS EN1092-1:2002 PN16

Options:

VH50 Screwed NPT
 VH80+ Flanged BS1560 ANSI #150
 VH80+ Flanged BS1560 ANSI #300
 VH80+ Flanged BS10 Table A+

Dimension & Connection Data					
Unit Ref	Connection Size	H mm	L mm	Drain Size	Weight kg
VH50	2" BSP	210	150	¾" BSP	1.5
VH65	2½" BSP	230	175	¾" BSP	1.7
VH80	DN80 PN16	270	200	¾" BSP	2
VH100	DN100 PN16	300	225	1" BSP	6
VH150	DN150 PN16	325	250	1" BSP	12
VH200	DN200 PN16	375	350	1½" BSP	18
VH250	DN250 PN16	400	500	1½" BSP	25
VH300	DN300 PN16	450	600	2" BSP	32

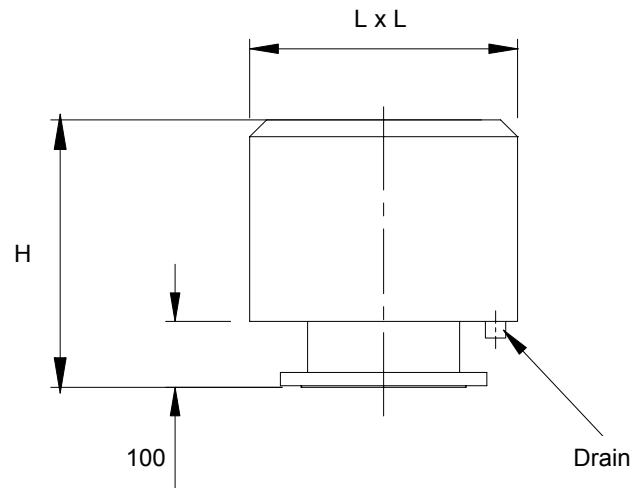

Please note all information shown within this leaflet is subject to change without prior notice.

© GMS Thermal Products 2004
 Issue 1, November 2004